

H&Ghouses

**This is the life**

Space was never an issue in this large terrace but it took a reconfigured layout and a well-considered decorating approach to make it sing as a home for three teens and their parents. Previously formal sitting rooms are now relaxed, cosy and well-used while the high-traffic rear living zones are casual and low-maintenance.



H&G houses

'While the palette is sophisticated,  
the furniture is relaxed, to  
encourage daily use.' SARAH-JANE PYKE



**T**here are so many ways to tackle the modernising of a traditional terrace. In this instance, it took a deliberately decorative approach to help an old Victorian get with the times.

The eastern Sydney property is home to Sally and Ewen and their daughters Hannah, 16, Molly, 13, and Clare, 12. They bought it in 2005 and worked with builder James Morrison to restore the home's period features and revise the layout to suit contemporary family living. The proportions were generous: a six-metre-wide frontage plus five bedrooms, three living areas and a library over three storeys. But the home lacked comfort and style, and with three teenage girls to consider, the couple called on interior designers Juliette Arent and Sarah-Jane Pyke from Arent & Pyke to add the finishing touches to this substantial home.

The front door opens to a grand hallway that runs through to a courtyard at the rear of the house. To the left of the entrance is the elegant sitting room, which is separated from the formal living room next door by a bank of bifold doors, allowing the rooms to be closed off or opened up as needed. Further up the hall is a bathroom/laundry and finally a light-filled open-plan kitchen/dining/living area at the rear of the home. Up a jarrah staircase leading off the hallway are four bedrooms and a family bathroom. A fifth bedroom (with ensuite) and a library are on the second floor.

The brief to Juliette and Sarah-Jane was that the decor should flow as easily as the new layout. In the front sitting and living rooms, select furnishings in vivid colours offer a counterpoint to



the period architectural features and create a link with the contemporary open-plan space at the rear of the home. "The front rooms are usually over-decorated in traditional terraces," says Sarah-Jane, "so while the palette is sophisticated, the furniture is relaxed, to encourage daily use."

"In the sitting room, we took two traditional mini-wingback chairs and upholstered them in contrasting plain and patterned fabrics to bring them up to date," says Juliette.

The open-plan area at the rear of the house follows this theme. An energetic mix of gorgeous fabrics and modern designer furniture, such as Walter Knoll Flow chairs, an Eames coffee table and a Cappellini Elan sofa, balance the white joinery, walls and floors. The sofa and dining banquette are upholstered in outdoor fabrics for easy cleaning, but also because these fabrics resist fading – an important consideration in this sunny space. Customised storage nooks, cabinets and drawers in the >

**ABOVE** In the formal living room, the designers chose relaxed and inviting furniture. Gervasoni Ghost sofas upholstered in Linux 20 fabric from Anibou. Floral cushions from Megan Park. Side table from Temperature Design. Eames coffee table from Living Edge. Pendant light from Tangent Lights. Sisal rug from International Floorcoverings. Artwork by Celia Gullett. **OPPOSITE** Stylised florals in bold hues give the sitting room a contemporary edge. Lamp, side table and chair, all from Temperature Design. Chair upholstered in Sanderson Honesty in Cerise and Sanderson Lusso in Shale. Rug from Designer Rugs. **For Where to Buy, see page 219.**



If colour plays a supporting role on the ground floor, it is given more latitude on the upper floors.

#### FIRST FLOOR



#### SECOND FLOOR



#### GROUND FLOOR

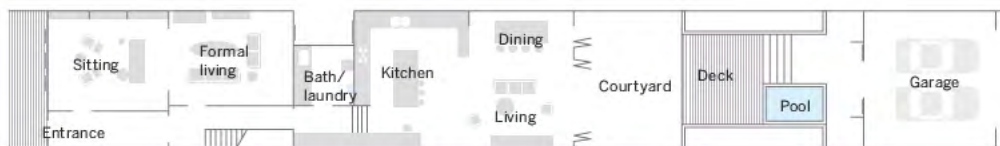

**ABOVE LEFT** Hannah's bedroom is a sophisticated teenage retreat. Cole & Son Catwalk wallpaper and cushions in Ralph Lauren Racing Stripe outdoor fabric, all from Radford Furnishings. Bed and bedside table, both from Zuster. Lamp from Artlight. **ABOVE RIGHT** Candy pink Bisazza mosaic tiles from Pazotti Tiles+Stone in the bathroom are a fun decorating touch that tie in with the downstairs colour scheme. Bath, basin, vanity and tapware from Domayne. **OPPOSITE** The large-scale print on the Cole & Son Fioretti wallpaper, from Radford Furnishings, creates a more intimate feel in the generous main bedroom. Bed from Jordan. Bed upholstered in Westbury Textiles Geneva in Silver Grey. Cushions in Jim Thompson New Silk Twill from Cline & Co. Lamp from Ondene. Bedside table from Zuster. Rug from Mr Carpet. **For Where to Buy, see page 219.**

### Decorator's diary

"We always ensure there is plenty of storage in the bedside units to neatly stow away personal items," says interior designer Juliette Arént.

"The children's rooms have built-in shelves to display their collection of books and mementos," she says.

"Sally and Ewen trusted that our schemes would give warmth and character to their house and the outcome reflects their personalities perfectly." ▶



**‘James, Sarah-Jane and Juliette were brilliant at turning our ideas into reality. We have exactly the home we always wanted.’ SALLY**

< kitchen handle all the trappings of the day, preventing the clutter from filtering through to the rest of the house.

Stacking doors leading to the courtyard are often open, extending the space and enhancing the casual feel of this zone.

If colour plays a supporting role on the ground floor, it is given more latitude on the upper floors. The girls’ bedrooms have been personalised with feature walls, bedheads, ottomans, desks, lighting and accessories in fabulous patterned fabrics. The family bathroom, too, is a riot of candy pink mosaics.

In the main bedroom, hand-printed wallpaper in soft lilac tones helps to create a more intimate feel in the vast space. “The right size pattern can really keep a room together,” says Sarah-Jane.

The renovation took a total of nine months and each member of the family

was involved in the decision-making at every stage. Even when Ewen’s work took him overseas for an extended period halfway through the renovation, he remained involved with the project via Skype and email.

The revitalised home is a picture of modernity. Thanks to a great builder and inspired interior choices, a consistent level of elegant living has been achieved – without detracting from the property’s inherent grandeur. “James, Sarah-Jane and Juliette were brilliant at turning our ideas into reality,” says Sally. “We have exactly the home we always wanted.” **H&G**

**Interior designer: Arent & Pyke, Potts Point, NSW; (02) 9331 2802 or arentpyke.com. Builder: James Morrison Construction, Bayview, NSW; 0415 416 564.**



**THIS PAGE, CLOCKWISE FROM TOP LEFT** Plenty of built-in storage in the kitchen helps keep the home clutter-free. Stools from Thonet. Pendant light from Space. In the dining area, a table from Chuck & Bob is teamed with chairs from Schamberg+Alvisse. The banquette is upholstered in Karin Sajo Riviera outdoor fabric in Violet from Julia Garner Agencies. Low-maintenance coloured-concrete flooring is used in the open-plan area. **OPPOSITE** The casual living area opens onto a paved courtyard. Markilux awning from Homelife Furnishings. Stacking doors from Windoor. Eames coffee table and Walter Knoll chairs and footstool in Mokum Souk, all from Living Edge. Cappellini sofa and stools from Dedec. Sofa upholstered in Unique Fabrics Marine Ottoman outdoor fabric in Onyx. Entertainment unit from Zuster. Artwork from PrintDolls. Rug from Robyn Cosgrove Rugs. Butterfly chair from 506070. **For Where to Buy, see page 219.**

## Colour palette



Resene Tea (sitting and formal living rooms)

Dulux Vivid White (kitchen/living area)



Resene Thorndon Cream (entrance hall)

## Add a dash of...



Wattyl Sunset Sari

Accents in jewel tones instantly update a period property.

